



User Manual

Foldable Electric Scooter

————— **H100** —————

Thanks for choosing our product. Have fun with this electric scooter.

Contents

1. Product Description.....	03
Tyre Installation.....	04
Folding.....	05
Handlebar Installation.....	06
Product Specification/Product Packing List.....	07
2. Warning.....	08
3. Safety Precautions.....	09
5. Maintenance.....	10
6.After Sale Service.....	11
7. Safety Recommendations.....	12
8.Daily Maintenance and storage.....	13

01 Product Description

Product Structure



ClassicTrot pro



User Manual

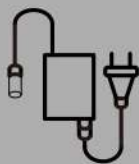

Charger &
Charger cable



Fender



Tyre Installation



- ▶ Install the quick release parts in turn to the front wheel.



- ▶ Loosen the nut and put the front wheel in the middle of the fork.



- ▶ Slightly minor force launching, quitting fast speed leisurely fitting, fitting before wheelchair, finished inexpensive hard rocking, jumping one piece swinging dynamic phenomenon.



- ▶ For your safety, please check regularly to see if the quick release is loosen, install the wrench in the proper direction at 10 o'clock on the quick release wrench.



Folding



- ▶ Lift the pole into a vertical position

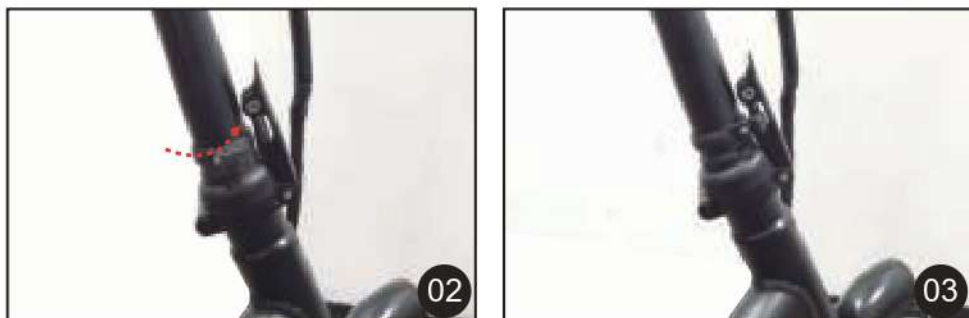

- ▶ Lock the lever

- ▶ Insert the hook through the special ring



Handlebar Installation



- ▶ Loosen the quick release part



- ▶ The screw is knocked down and the lid is removed



- ▶ Put the handlebars in the slots



- ▶ Cover the lid, tighten the screw and install the quick release part



- ▶ Adjust the handlebars are in the proper position and then lock the lever

Product Specification

	Specification	Details
1	Model name	H100
2	Product size	Unfold:1660*600*1120MM,Fold: 1660*140*760cm
3	Max load	120kg
4	Top Speed	25km/h
5	Motor	36V*350W motor
6	Battery	Lithium (36V/10Ah)
7	Tire	Front wheel 20" Pneumatic tire
		Rear wheel 16" Pneumatic tire
8	Charging time	5-6 Hours

Product Packing List

H100 includes the following: (please inspect and contact authorized dealers or post sales support department to replace any missing items.)

Scooter body	Fender
Charger	Owner's Manual
Installation tool &Screws	

02 Warning!

Please inspect before riding.

1. Handle bar (Check to make sure the handle bar screws are not loose).
2. Front and rear brake (Be sure brakes are fully engaging).
3. Fender (Does not interfere with the tire).
4. Battery (Check to make sure battery is charged).
5. Tire (Check tires for damage, ensure tires are properly inflated).
6. Front and rear wheels (Securely fastened).
7. Motor (Operating properly).

03 Safety Precautions!

1. Always ride with a helmet and protective gear.
2. Do not ride with more than one person at any time.
3. Do not immerse scooter in water.
4. Always ride with two hands.
5. Do not ride up or down stairs.
6. Use both front and rear brakes when stopping.
7. Do not ride the scooter at night.
8. Wear proper footwear.
9. Do not use mobile phones while riding.
10. Be aware of your surroundings when riding the scooter.
11. Do not ride when you are not feeling well such as drunk or taking medicinal.

05 Maintenance!

Your Electric Scooter should be regularly maintained.

1. Operating System: Some parts need to be lubricated.
 - Brake rod (front & rear)
 - Wire movement part (brake material: refined steel)
 - Wire loop section
 - Movable parts of accelerator
2. Brake: Check your brake pads often for wear and tear. If you find rust or wear, or it is unusable, brake is recommended to be replaced.
3. Shaft: Lubricate properly to ensure the front wheel, gear crank and rear wheel move smoothly.
4. Wire: Ensure your wiring cables are free of dust and moisture. Clean or lubricate as needed.
5. Tires
 - Do not over-inflate. Stay within recommended PSI which can be located on the sidewall of your tire.
 - Do not lubricate the tires and rims.
 - After using the tire for a long time, please replace the tire, which will prolong the use of the bicycle.

06 After Sale Service!

Assembly

The Electric Scooter is roughly 85% assembled, but does require some assembly. For safety, please check and test everything before riding. After inspection and adjustments, if there are any issues, please contact your authorized dealer.

Damage and Scratches

To avoid damage, scooters are packed with foam and cardboard. If some parts are broken, please take some photos and contact your authorized dealer for more information and assistance.

Summer is a season that makes it easy to puncture tires. Please be careful. It is necessary to check the tires before putting the air in the tire.

It is necessary to check the tires before putting the air in the tire.

- Check the amount of air in your tire.
- Due to higher temperatures, there may be thermal expansion. Inspect PSI to ensure you're within proper guidelines.
- Please check whether the tip gap is removed.

About Configurations

Due to mass production and different batches, please understand that the item may not be the same as the pictures in the brochure, but we guarantee that the changed parts will be updated.

07 Safety Recommendations

1. For your safety and the safety of others, you must follow the instructions outlined in this manual .
2. Risk of injury, due to improper operation of the unit may occur. On smooth surfaces, emergency braking may cause skidding and loss of balance.
3. While riding, maintain an appropriate distance from pedestrians and reduce speeds while passing them.
4. Always follow local driving laws. Violation of the above rules may result in personal injury. We are not responsible for any injuries.
5. Inspect your scooter carefully before each use. If you find broken parts, decreased battery life, air leaking from tires, excessive wear, or abnormal noises when riding, please discontinue use of the scooter immediately and contact your authorized dealer.

08 Daily Maintenance and storage

Clean and Store Electric Scooter

If you find any stains on electric scooter housing, use a soft, damp cloth to wipe the vehicle.

Warning: Do not use alcohol, gasoline, kerosene or other corrosive solutions, volatile chemical solvents to clean the scooter. It will cause serious damage to the scooter body. Do not wash electric scooter with high pressure. Make sure the scooter is off before washing and the plug cover is in the charging port otherwise you may get an electric shock or cause serious damage.

When you are not using the scooter, store it in a cool, dry place. Leaving the device in sun or in extremely high or low temperatures can cause a reduced battery life.

Maintenance of Electric Scooter Battery

1. Do not use batteries from other brands.
2. Do not open or disassemble the battery to prevent electric shock. Avoid contact with metal objects to prevent a short circuit. The battery may malfunction or can cause injury.
3. Use the supplied AC adapter to prevent malfunction and reduce the risk of overheating.
4. Only dispose of batteries in accordance with local laws.
5. Charge the battery after each use to prolong battery life.

Do not store the battery in rooms with temperatures that exceed 122 degrees F or -10 degrees F. This may cause the battery to deteriorate. Do not leave the battery near fire. As a result of these actions may deteriorate the battery, overheating and can even cause inflammation.

If within 30 days the scooter is not used, charge the battery and keep the device in a cool, dry place. Every 60 days you need to charge the battery, otherwise there is the likelihood of its failure, which is not subject to warranty services.

Avoid a full discharge of the device, it will reduce the battery life. When using the device at normal room temperature, the battery will be able to ride much greater distance and its performance will be improved.

Note: A fully charge scooter runs about 120-180 days of standby time. The battery has a smart chip, that stores information about its charging-discharging. If you are not charging the battery for a long time, it can cause serious damage, for which it decreases the capability to charge the device again. This kind of damage is not included in warranty service. (Caution: Do not disassemble the device by unauthorized people, as there is a risk of electric shock or serious injury as result of a short circuit.

Adjusting a brake disc

If the brake is tight, using a M5 hex wrench and loosen screws of brake disc tensioner pulley, slightly shorten a length of a tail brake cable, then re-tighten a tensioner pulley.

If you feel the brake is loose, loosen tension pulley screw, pull the brake cable to slightly tighten and increase a length of its tail. Re-tighten tension pulley screws.

Adjusting handle bars

Use a M5 hex wrench, loosen and tighten two screws near the folding mechanism to adjust handle bars to desired setting.